

ART. 040

design: studio Mital



Pomolo in ceramica con bussola in ottone.
Base in ottone tornito, completo di vite M4 x 25

Materiale: ceramica e ottone

Ceramic knob with brass bush. Turned brass base with screw M4 x 25

Material: brass and ceramic

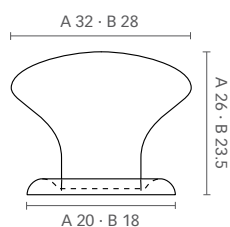

Finiture • Finishes

Ottone • Brass

Bronzo anticato
Antique bronze

Placcato oro
Gold plated

Econichel
Econickel

Ceramica • Ceramic

Bianco con fiore colorato
White with colored flower

Bianco con fiore blu
White with blue flower

Beige con fiore
Beige with flower